

Double Hung Multiple Unit Charts

Double Hung Twin Mulled Units

Glass Height	R.O. Height	16" Glass	20" Glass	24" Glass	28" Glass	32" Glass	36" Glass	40" Glass
		R.O. Width 3' 7 ¼"	R.O. Width 4' 3 ¼"	R.O. Width 4' 11 ¼"	R.O. Width 5' 7 ¼"	R.O. Width 6' 3 ¼"	R.O. Width 6' 11 ¼"	R.O. Width 7' 7 ¼"
12"	2' 9"	DH2-1612	DH2-2012	DH2-2412	DH2-2812	DH2-3212	DH2-3612	DH2-4012
14"	3' 1"	DH2-1614	DH2-2014	DH2-2414	DH2-2814	DH2-3214	DH2-3614	DH2-4014
16"	3' 5"	DH2-1616	DH2-2016	DH2-2416	DH2-2816	DH2-3216	DH2-3616	DH2-4016
18"	3' 9"	DH2-1618	DH2-2018	DH2-2418	DH2-2818	DH2-3218	DH2-3618	DH2-4018
20"	4' 1"	DH2-1620	DH2-2020	DH2-2420	DH2-2820	DH2-3220	DH2-3620	DH2-4020
22"	4' 5"	DH2-1622	DH2-2022	DH2-2422	DH2-2822	DH2-3222	DH2-3622	DH2-4022
24"	4' 9"	DH2-1624	DH2-2024	DH2-2424	DH2-2824	DH2-3224	DH2-3624	DH2-4024
26"	5' 1"	DH2-1626	DH2-2026	DH2-2426	DH2-2826	DH2-3226	DH2-3626	DH2-4026
28"	5' 5"	DH2-1628	DH2-2028	DH2-2428	DH2-2828	DH2-3228	DH2-3628	DH2-4028
30"	5' 9"	DH2-1630	DH2-2030	DH2-2430	DH2-2830	DH2-3230	DH2-3630	DH2-4030
32"	6' 1"	DH2-1632	DH2-2032	DH2-2432	DH2-2832	DH2-3232	DH2-3632	DH2-4032
34"	6' 5"	DH2-1634	DH2-2034	DH2-2434	DH2-2834	DH2-3234	DH2-3634	DH2-4034
36"	6' 9"	DH2-1636	DH2-2036	DH2-2436	DH2-2836	DH2-3236	DH2-3636	DH2-4036

Double Hung Triple Mulled Units

Glass Height	R.O. Height	16" Glass	20" Glass	24" Glass	28" Glass	32" Glass	36" Glass	40" Glass
		R.O. Width 5' 4 ⅝"	R.O. Width 6' 4 ⅝"	R.O. Width 7' 4 ⅝"	R.O. Width 8' 4 ⅝"	R.O. Width 9' 4 ⅝"	R.O. Width 10' 4 ⅝"	R.O. Width 11' 4 ⅝"
12"	2' 9"	DH3-1612	DH3-2012	DH3-2412	DH3-2812	DH3-3212	DH3-3612	DH3-4012
14"	3' 1"	DH3-1614	DH3-2014	DH3-2414	DH3-2814	DH3-3214	DH3-3614	DH3-4014
16"	3' 5"	DH3-1616	DH3-2016	DH3-2416	DH3-2816	DH3-3216	DH3-3616	DH3-4016
18"	3' 9"	DH3-1618	DH3-2018	DH3-2418	DH3-2818	DH3-3218	DH3-3618	DH3-4018
20"	4' 1"	DH3-1620	DH3-2020	DH3-2420	DH3-2820	DH3-3220	DH3-3620	DH3-4020
22"	4' 5"	DH3-1622	DH3-2022	DH3-2422	DH3-2822	DH3-3222	DH3-3622	DH3-4022
24"	4' 9"	DH3-1624	DH3-2024	DH3-2424	DH3-2824	DH3-3224	DH3-3624	DH3-4024
26"	5' 1"	DH3-1626	DH3-2026	DH3-2426	DH3-2826	DH3-3226	DH3-3626	DH3-4026
28"	5' 5"	DH3-1628	DH3-2028	DH3-2428	DH3-2828	DH3-3228	DH3-3628	DH3-4028
30"	5' 9"	DH3-1630	DH3-2030	DH3-2430	DH2-2830	DH3-3230	DH3-3630	DH3-4030
32"	6' 1"	DH3-1632	DH3-2032	DH3-2432	DH3-3232	DH3-3232	DH3-3632	DH3-4032
34"	6' 5"	DH3-1634	DH3-2034	DH3-2434	DH3-2834	DH3-3234	DH3-3634	DH3-4034
36"	6' 9"	DH3-1636	DH3-2036	DH3-2436	DH3-2836	DH3-3236	DH3-3636	DH3-4036

Double Hung Transom Unit Charts

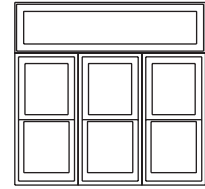
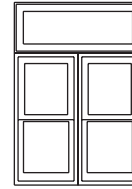
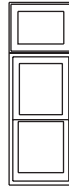

Frame Height	Width	1' 9 3/8"	3' 6 3/4"	5' 4 1/8"
	Glass	1 - 16	2 - 16	3 - 16
1' 1"	8	DT1-16/08-1	DT2-16/08-1	DT3-16/08-1
1' 5"	12	DT1-16/12-1	DT2-16/12-1	DT3-16/12-1
1' 9"	16	DT1-16/16-1	DT2-16/16-1	DT3-16/16-1
2' 1"	20	DT1-16/20-1	DT2-16/20-1	DT3-16/20-1
Frame Height	Width	2' 1 3/8"	4' 2 3/4"	6' 4 1/4"
	Glass	1 - 20	2 - 20	3 - 20
1' 1"	8	DT1-20/08-1	DT2-20/08-1	DT3-20/08-1
1' 5"	12	DT1-20/12-1	DT2-20/12-1	DT3-20/12-1
1' 9"	16	DT1-20/16-1	DT2-20/16-1	DT3-20/16-1
2' 1"	20	DT1-20/20-1	DT2-20/20-1	DT3-20/20-1
Frame Height	Width	2' 5 3/8"	4' 10 3/4"	7' 4 1/8"
	Glass	1 - 24	2 - 24	3 - 24
1' 1"	8	DT1-24/08-1	DT2-24/08-1	DT3-24/08-1
1' 5"	12	DT1-24/12-1	DT2-24/12-1	DT3-24/12-1
1' 9"	16	DT1-24/16-1	DT2-24/16-1	DT3-24/16-1
2' 1"	20	DT1-24/20-1	DT2-24/20-1	DT3-24/20-1
Frame Height	Width	2' 9 3/8"	5' 6 3/4"	7' 4 1/8"
	Glass	1 - 28	2 - 28	3 - 28
1' 1"	8	DT1-28/08-1	DT2-28/08-1	DT3-28/08-1
1' 5"	12	DT1-28/12-1	DT2-28/12-1	DT3-28/12-1
1' 9"	16	DT1-28/16-1	DT2-28/16-1	DT3-28/16-1
2' 1"	20	DT1-28/20-1	DT2-28/20-1	DT3-28/20-1
Frame Height	Width	3' 1 3/8"	6' 2 3/4"	9' 4 1/8"
	Glass	1 - 32	2 - 32	3 - 32
1' 1"	8	DT1-32/08-1	DT2-32/08-1	DT3-32/08-1
1' 5"	12	DT1-32/12-1	DT2-32/12-1	DT3-32/12-1
1' 9"	16	DT1-32/16-1	DT2-32/16-1	DT3-32/16-1
2' 1"	20	DT1-32/20-1	DT2-32/20-1	DT3-32/20-1
Frame Height	Width	3' 5 3/8"	6' 10 3/4"	10' 4 1/8"
	Glass	1 - 36	2 - 36	3 - 36
1' 1"	8	DT1-36/08-1	DT2-36/08-1	DT3-36/08-1
1' 5"	12	DT1-36/12-1	DT2-36/12-1	DT3-36/12-1
1' 9"	16	DT1-36/16-1	DT2-36/16-1	DT3-36/16-1
2' 1"	20	DT1-36/20-1	DT2-36/20-1	DT3-36/20-1
Frame Height	Width	3' 9 3/8"	7' 6 3/4"	11' 4 1/8"
	Glass	1 - 40	2 - 40	3 - 40
1' 1"	8	DT1-40/08-1	DT2-40/08-1	DT3-40/08-1
1' 5"	12	DT1-40/12-1	DT2-40/12-1	DT3-40/12-1
1' 9"	16	DT1-40/16-1	DT2-40/16-1	DT3-40/16-1
2' 1"	20	DT1-40/20-1	DT2-40/20-1	DT3-40/20-1

Double Hung Studio Sidelites Unit Elevations

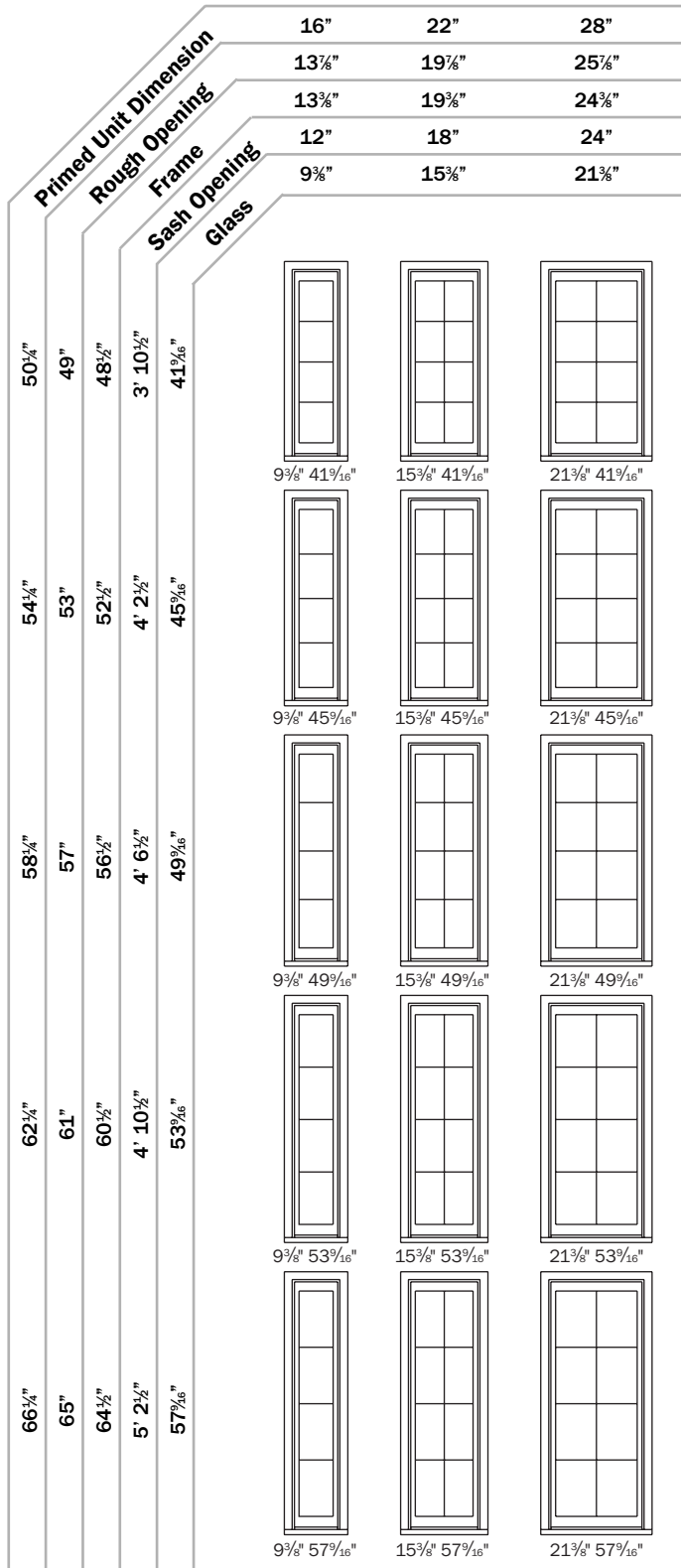

Double Hung Triple Picture Unit

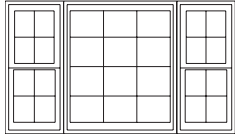

Double Hung Triple Picture Units consist of a Studio Unit Center with two single double hung flankers

Triple Picture Frame dimensions equal the sum of the individual boxes

Triple Picture Rough Opening Dimension equals the complete frame dimension plus $\frac{1}{2}$ "

Clad Triple Picture Unit Dimension – Same as Triple Picture Frame Dimension

Primed Triple Picture Unit Dimension equals the total Rough Opening plus $2\frac{1}{8}$ " in width and the Rough Opening plus $1\frac{1}{4}$ " in height

Masonry Opening: Recommended Minimum of Unit or Frame Dimension plus $\frac{1}{4}$ "

Double Hung Bay Windows (30°)

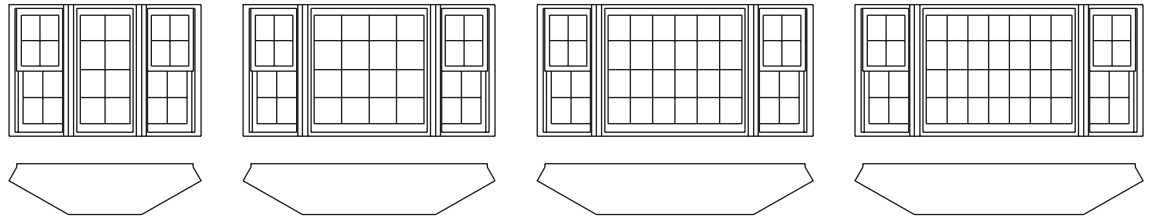

	Glass	16/33 $\frac{3}{16}$ "/16"	16/45 $\frac{3}{16}$ "/16"	16/49 $\frac{3}{16}$ "/16"	16/57 $\frac{3}{16}$ "/16"
Unit Dimension	Clad/WV	80"	92"	96"	104"
	Primed	82 $\frac{3}{16}$ "	94 $\frac{3}{16}$ "	98 $\frac{3}{16}$ "	106 $\frac{3}{16}$ "
Rough Opening	Clad/WV	79 $\frac{7}{16}$ "	91 $\frac{7}{16}$ "	95 $\frac{7}{16}$ "	103 $\frac{7}{16}$ "
	Primed	78 $\frac{11}{16}$ "	90 $\frac{11}{16}$ "	94 $\frac{11}{16}$ "	102 $\frac{11}{16}$ "
Projection	Clad/WV	12 $\frac{9}{16}$ "	12 $\frac{9}{16}$ "	12 $\frac{9}{16}$ "	12 $\frac{9}{16}$ "
	Primed	13"	13"	13"	13"

	Glass	20/33 $\frac{3}{16}$ "/20"	20/45 $\frac{3}{16}$ "/20"	20/49 $\frac{3}{16}$ "/20"	20/57 $\frac{3}{16}$ "/20"
Unit Dimension	Clad/WV	87"	99"	103"	111"
	Primed	89 $\frac{5}{16}$ "	101 $\frac{5}{16}$ "	105 $\frac{5}{16}$ "	113 $\frac{5}{16}$ "
Rough Opening	Clad/WV	86 $\frac{7}{16}$ "	98 $\frac{7}{16}$ "	102 $\frac{7}{16}$ "	110 $\frac{7}{16}$ "
	Primed	85 $\frac{1}{16}$ "	97 $\frac{1}{16}$ "	101 $\frac{1}{16}$ "	109 $\frac{1}{16}$ "
Projection	Clad/WV	14 $\frac{9}{16}$ "	14 $\frac{9}{16}$ "	14 $\frac{9}{16}$ "	14 $\frac{9}{16}$ "
	Primed	15"	15"	15"	15"

Vertical rough openings indicated are standard unit heights with $1\frac{1}{4}$ " added for head and seat boards – deduct for walk out unit

Vertical unit dimensions reflect clad to clad and brickmould to sill nosing. The use of head and seat boards will add an additional $1\frac{1}{4}$ " to the overall frame height.

Glass Heights	Unit Dimension Clad/Primed Heights	Rough Opening Heights
20"	48 $\frac{1}{2}$ "/50 $\frac{1}{4}$ "	50"
22"	52 $\frac{1}{2}$ "/54 $\frac{1}{4}$ "	54"
24"	56 $\frac{1}{2}$ "/58 $\frac{1}{4}$ "	58"
28"	64 $\frac{1}{2}$ "/66 $\frac{1}{4}$ "	66"
30"	68 $\frac{1}{2}$ "/70 $\frac{1}{4}$ "	70"

Double Hung Bay Windows (45°)

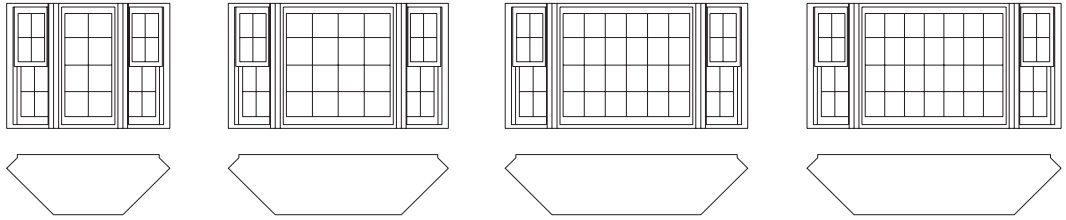

	Glass	16/33³/₁₆"/16"	16/45³/₁₆"/16"	16/49³/₁₆"/16"	16/57³/₁₆"/16"
Unit Dimension	Clad/WV	75 ⁵ / ₈ "	87 ⁵ / ₈ "	91 ⁵ / ₈ "	99 ⁵ / ₈ "
	Primed	77 ³ / ₁₆ "	89 ³ / ₁₆ "	93 ³ / ₁₆ "	101 ³ / ₁₆ "
Rough Opening	Clad/WV	75"	87"	91"	99"
	Primed	72 ⁵ / ₈ "	84 ⁵ / ₈ "	88 ⁵ / ₈ "	96 ⁵ / ₈ "
Projection	Clad/WV	17 ³ / ₄ "	17 ³ / ₄ "	17 ³ / ₄ "	17 ³ / ₄ "
	Primed	18 ⁷ / ₁₆ "	18 ⁷ / ₁₆ "	18 ⁷ / ₁₆ "	18 ⁷ / ₁₆ "

	Glass	20/33³/₁₆"/20"	20/45³/₁₆"/20"	20/49³/₁₆"/20"	20/57³/₁₆"/20"
Unit Dimension	Clad/WV	81 ¹ / ₄ "	93 ¹ / ₄ "	97 ¹ / ₄ "	105 ¹ / ₄ "
	Primed	83 ³ / ₁₆ "	95 ³ / ₁₆ "	99 ³ / ₁₆ "	107 ³ / ₁₆ "
Rough Opening	Clad/WV	80 ⁵ / ₈ "	92 ⁵ / ₈ "	96 ⁵ / ₈ "	104 ⁵ / ₈ "
	Primed	78 ⁵ / ₁₆ "	90 ⁵ / ₁₆ "	94 ⁵ / ₁₆ "	102 ⁵ / ₁₆ "
Projection	Clad/WV	20 ³ / ₁₆ "	20 ³ / ₁₆ "	20 ³ / ₁₆ "	20 ³ / ₁₆ "
	Primed	21 ¹ / ₄ "	21 ¹ / ₄ "	21 ¹ / ₄ "	21 ¹ / ₄ "

Vertical rough openings indicated are standard unit heights with 1¹/₄" added for head and seat boards – deduct for walk out unit

Vertical unit dimensions reflect clad to clad and brick-mould to sill nosing. The use of head and seat boards will add an additional 1¹/₄" to the overall frame height.

Glass Heights	Unit Dimension Clad/Primed Heights	Rough Opening Heights
20"	48 ¹ / ₂ " / 50 ¹ / ₄ "	50 ¹ / ₄ "
22"	52 ¹ / ₂ " / 54 ¹ / ₄ "	54 ¹ / ₄ "
24"	56 ¹ / ₂ " / 58 ¹ / ₄ "	58 ¹ / ₄ "
28"	64 ¹ / ₂ " / 66 ¹ / ₄ "	66 ¹ / ₄ "
30"	68 ¹ / ₂ " / 70 ¹ / ₄ "	70 ¹ / ₄ "

Double Hung Radius Head

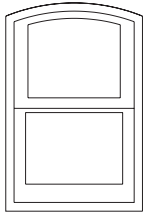

Segment head single hungs are available as primed wood units only. Glass sizes 20 through 32 inch width have a standard radius. As a custom unit it may be ordered with a custom radius to include a true extended leg half round top sash. The unit offers a half screen.

Double Hung Cottage & Oriel

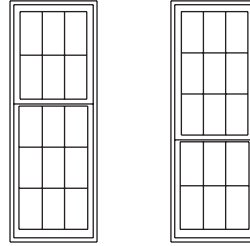

Cottage and Oriel style double hung windows are available in all three exterior options; primed, clad and W-V. Standard units are comprised of all standard widths and a 5'-6" sash opening height. Custom sizing is available. Maximum size may not exceed a 40" glass width or a 36" glass height.

Double Hung Replacement Sash Kits

Glass Height	Width	16"	20"	24"	28"	32"	36"	40"
	Sash Opening	1'-8"	2'-0"	2'-4"	2'-8"	3'-0"	3'-4"	3'-8"
12"	2'-6"	1612	2012	2412	2812	3212	3612	4012
14"	2'-10"	1614	2014	2414	2814	3214	3614	4014
16"	3'-2"	1616	2016	2416	2816	3216	3616	4016
18"	3'-6"	1618	2018	2418	2818	3218	3618	4018
20"	3'-10"	1620	2020	2420	2820	3220	3620	4020
22"	4'-2"	1622	2022	2422	2822	3222	3622	4022
24"	4'-6"	1624	2024	2424	2824	3224	3624	4024
26"	4'-10"	1626	2026	2426	2826	3226	3626	4026
28"	5'-2"	1628	2028	2428	2828	3228	3628	4028
30"	5'-6"	1630	2030	2430	2830	3230	3630	4030
24/36"	5'-6"	1624/36	2024/36	2424/36	2824/36	3224/36	3624/36	4024/36
32"	5'-10"	1632	2032	2432	2832	3232	3632	4032
34"	6'-2"	1634	2034	2434	2834	3234	3634	4034
36"	6'-6"	1636	2036	2436	2836	3236	3636	4036